

# TLF.

Adjustable hook clamps

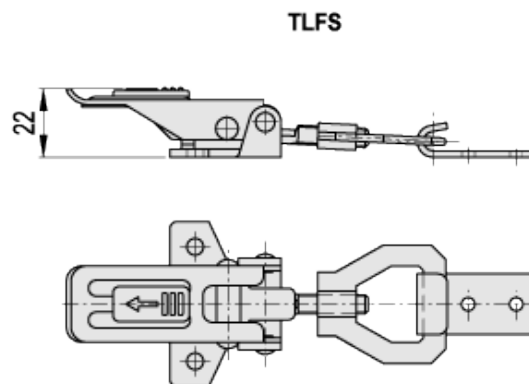

**INOX**  
Stainless Steel

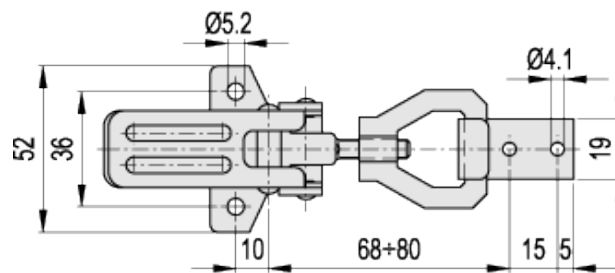
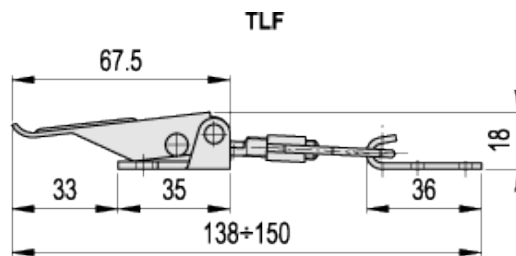

technical informations  
Standard executions  
- TLF: basic hook clamps.

- TLFS: hook clamps with security stop. RAL 3000 red technopolymer push button.
- Index for material and surface treatment to add to standard executions:
- Z: zinc-plated steel.
- SST: AISI 304 stainless steel.
- NH: nickel-plated steel.

*Special executions on request*

- Hook clamps in unplated steel.
- Catch brackets in different shapes and finishes.

Radial strength tests



Standard Elements		Maximum working load	Load at breakage	Weight
Code	Description	[N]	[N]	g
420101	TLF.Z-24/138-150+R	1500	2500	101
420102	TLF.SST-24/138-150+R	1500	2500	101
420103	TLFS.NH-24/138-150+R	1500	2500	103
420104	TLFS.SST-24/138-150+R	1500	2500	103



ELESA and GANTER models all rights reserved in accordance with the law. Always mention the source when reproducing our drawings.

STANDARD MACHINE ELEMENTS WORLDWIDE