

LeanFoam insert for Milwaukee Packout suitcase

- To independently create a foam insert inside the suitcase
- enables safe storage of items and tools
- enables quick identification of missing elements
- foam tailored to the shape of the internal suitcase

Specifications:

- outer dimensions 500 x 320 mm
- thickness 40 mm +/- 3 mm
- density 20kg/m³ +/- 10%
- odorless
- chemically neutral
- resistant to mold and moisture
- waterproof
- recyclable



LeanFoam

wiesz czego Ci brakuje

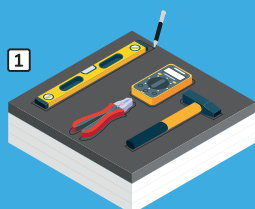

1 Arrange the tools and trace their shapes

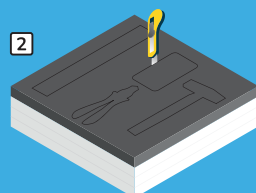

2 Cut the foam to the appropriate depth

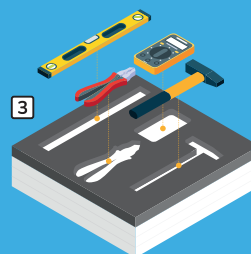

3 Select the cut material and arrange the tools

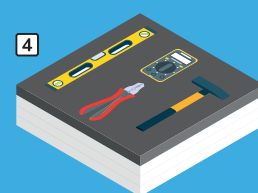

4 READY!



All LeanFoam inserts are available in four colors