

Series 82 Illuminated pushbutton Ø 22 mm stainless steel 304, with illuminated symbol.

Part No: 82-6151.2AA4.B001

Technical data



Mounting cut-out	22 mm
Terminal	Soldering terminal, 2.8 x 0.5 mm
Shape of illumination	Symbol
Operating voltage (LED)	24 V DC
OperatingTravel	ca. 3 mm
Lens illumination	illuminative
Lens colour	Silver
Lens shape	flush
Lens material	Plastic metalised
Lens optics	opaque
Front bezel shape	flush
Front bezel material	Stainless steel
Weight	0.025 kg
Contact material	Silver
Illumination colour	Red/Green
Kind of illumination	Bi-colour-LED
Switching action	Maintained
Switching system	Snap-action switching element
Symbol	ON/OFF
Contacts	1C
Operating temperature	- 30 °C ... + 70 °C
Approbations	CB, CCC, C UL, UL
Operating force	4 ... 7 N
Climate resistance	Damp heat, 21 days according to IEC 60512-11
Switching Voltage	240 V AC
Switching Current	3 A

Dimensions

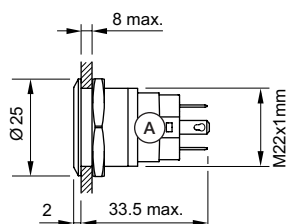

Mounting cut-outs

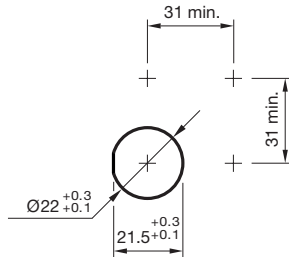

Wiring diagrams

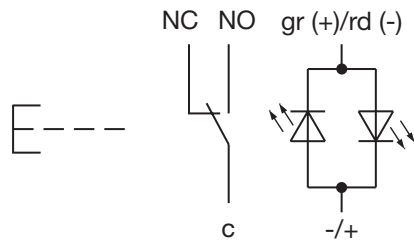

Component layouts

