

Data sheet Pushbutton Ø 16 mm silver contact.

Part No.: 82-4551.1000

Technical data



Terminal	Soldering terminal, 0.5 x 2.8 mm
Operating Travel	ca. 3 mm
Lens illumination	non illuminative
Lens colour	Nature
Lens shape	flush
Lens material	Aluminium
Lens surface	anodised
Lens optics	opaque
Front bezel shape	flush
Front bezel material	Aluminium
Weight	0.018 kg
Contact material	Silver
Switching action	Momentary
Switching system	Snap-action switching element
Contacts	1 FS
Operating temperature	- 30 °C ... + 70 °C
Approbations	CB, CCC, C UL, UL
Operating force	4 ... 7 N
Climate resistance	Damp heat, 21 days according to IEC 60512-11

Dimensions

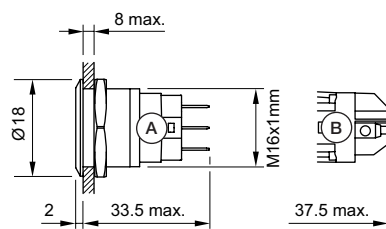

A = Solder terminal
B = Screw terminal

Mounting cut-outs

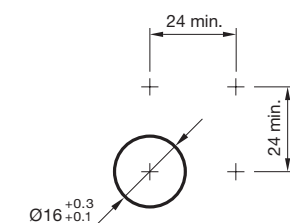

Wiring diagrams

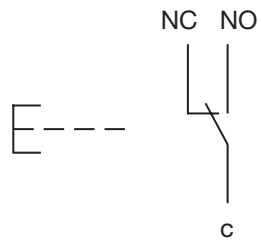

Component layouts

