

MATERIALS AND FINISHES

BODY BRASS
PLATED GOLD

CENTER CONTACT BERYLLIUM COPPER
PLATED GOLD

INSULATOR TEFLON

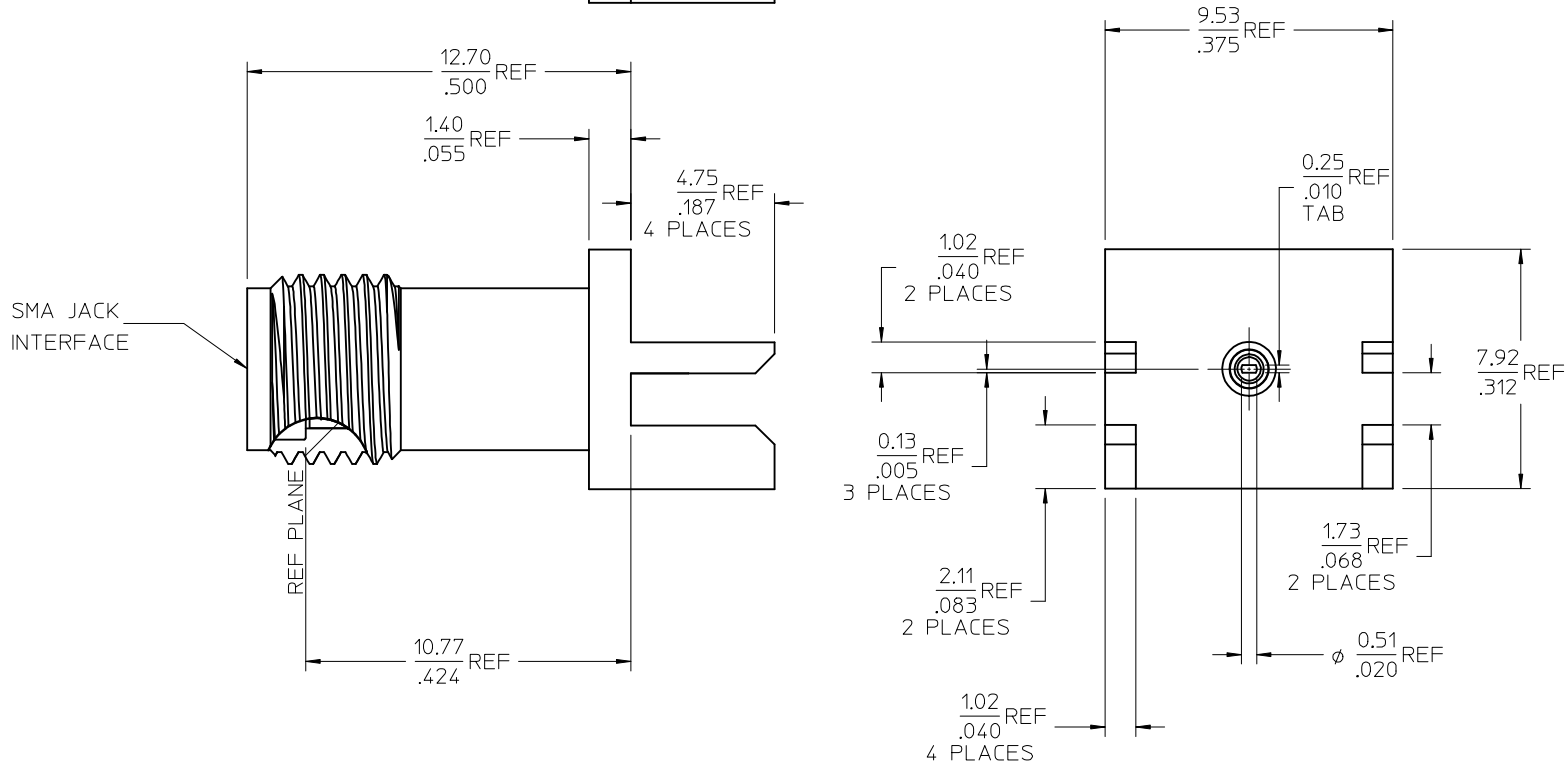
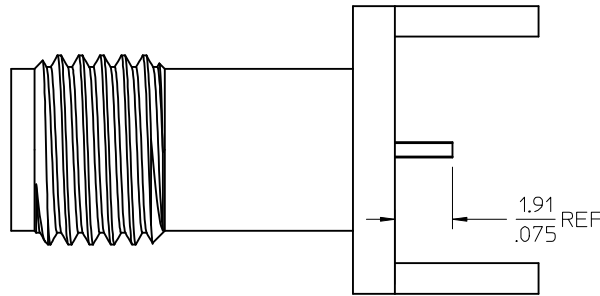
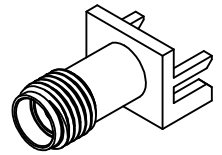

PS-89675-2820	PRODUCT SPECIFICATION
MIL-STD-348A, FIG. 310.2	INTERFACE
SPECIFICATION	DESCRIPTION

73251-0621	73251-0620, ONE PER BAG
73251-0620	BULK
PART NO.	PACKAGING

CHG: REDRAWN TO SHOW REVISED COMPONENTS	EC NO: URF2008-0025	2007/07/13
	DRWN: TELAHERTY	2007/07/13
A2	CHKD: SSHAH	2007/07/13
	APPR: JWENER	2007/07/13

QUALITY SYMBOLS	GENERAL TOLERANCES (UNLESS SPECIFIED)
▽=0	mm INCH
▽=0	4 PLACES ± --- ± ---
	3 PLACES ± --- ± ---
	2 PLACES ± --- ± ---
	1 PLACE ± --- ± ---
	ANGULAR ± 2 °
	DRAFT WHERE APPLICABLE MUST REMAIN WITHIN DIMENSIONS

DIMENSION STYLE		SCALE	DESIGN UNITS	THIRD ANGLE PROJECTION
MM/IN			METRIC	
DRAWN BY	DATE	TITLE		
GMH	1998/10/13	SMA JACK, EDGE MOUNT		
CHECKED BY	DATE	50 OHMS, EWR-3335		
APPROVED BY	DATE	SMA-JR		
MATERIAL NO.	DOCUMENT NO.	MOLEX INCORPORATED		
SEE TABLE		SD-73251-062		
SIZE		SHEET NO. 1 OF 1		

DRAWN BY		DATE	TITLE	
GMH		1998/10/13	SMA JACK, EDGE MOUNT	
CHECKED BY		DATE	50 OHMS, EWR-3335	
APPROVED BY		DATE	SMA-JR	
MATERIAL NO.		DOCUMENT NO.	MOLEX INCORPORATED	
SEE TABLE			SD-73251-062	
SIZE			SHEET NO. 1 OF 1	