

# NDA.Q



End-caps for square tubes with adjustable height levelling element



NDA.Q-20 + NDA.Q-25

NDA.Q-30 + NDA.Q-50

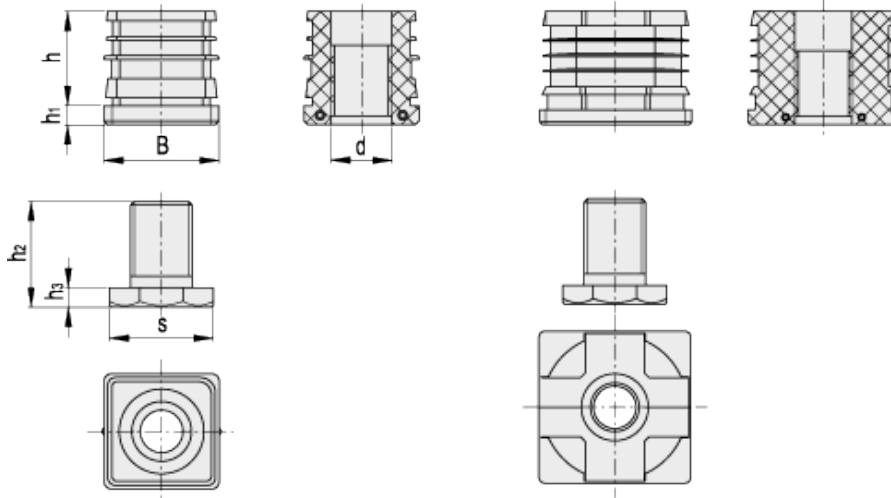

## technical informations

### Material

Polyamide (PA) based tecnopolymer.  
Resistant to solvents, oils, greases and other chemical agents.

### Colour

Black, matte finish.

### Features and applications

End-caps for square tubes with adjustable height levelling element. The assembly can be performed simply by positioning the end-cap, forcing it, inside the tube, with no need of screws or other fasteners.

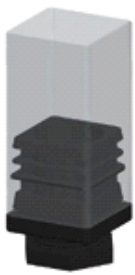

Standard Elements		Main dimensions							Tube dimensions			Max limit static load*	Weight
Code	Description	B	h	h <sub>1</sub>	s	h <sub>2</sub>	h <sub>3</sub>	d	External	Thickness <sub>min-max</sub>	Internal <sub>max-min</sub>	[N]	g
430401	NDA.Q-20-M12x30	20	34	5	SW19	32	5	M12	20	1.5-2	17-16	1000	9
430406	NDA.Q-22-M12x30	22	34	5	SW19	32	5	M12	22	1.5-2	19-18	1000	11
430411	NDA.Q-25-M12x30	25	34	5	SW19	32	5	M12	25	1.5-2	22-21	1000	14
430416	NDA.Q-25-M16x30	25	34	5	SW27	37	5	M16	25	1.5-2	22-21	1500	15
430421	NDA.Q-30-M16x30	30	25	5	SW27	37	5	M16	30	1.5-2	27-26	1500	20
430426	NDA.Q-30-M22x30	30	26	5	SW27	35	5	M22	30	1.5-2	27-26	2500	16
430431	NDA.Q-35-M22x30	35	34	5	SW27	35	5	M22	35	1.5-2	32-31	2500	21
430436	NDA.Q-40-M22x30	40	33	5	SW27	35	5	M22	40	1.5-2	37-36	2500	30
430441	NDA.Q-45-M22x30	45	34	5	SW27	35	5	M22	45	1.5-2	42-41	2500	34
430446	NDA.Q-50-M22x30	50	34	5	SW27	35	5	M22	50	1-1.5	48-47	2500	42

\* The value refers to laboratory tests carried out with a load applied vertically to the leveling element unscrewed from the end-cap of 10 mm and leaning on a flat surface.  
 The max limit static load is the value above which the load applied to the element may cause some plastic material breakage, under particular conditions of use. Obviously, a factor that takes into consideration the importance and the safety level of the specific application must be applied to this value.



ELESA and GANTER models all rights reserved in accordance with the law. Always mention the source when reproducing our drawings.

**STANDARD MACHINE ELEMENTS WORLDWIDE**