

order number: J80120A0220

STX M12x1 BS D-cod. Cat.5, BS4D180-2-1THR100BM000

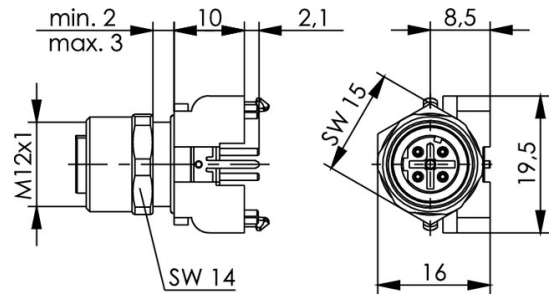

Fig. may differ



| Technical Attributes | |
|----------------------|--|
| Description | STX M12x1 BS D-cod. Cat.5 |
| Short name | BS4D180-2-1THR100BM000 |
| Type | 4 pole, D-coded, straight, 1pc. design, screen connection quad, solder connection THR, gap to PCB 10 mm, back mounting |

| Mechanical Characteristics | |
|------------------------------|--|
| Durability (Matings) | ≥ 100 |
| Cu-Conductor diameter: solid | 0.51 - 1.0 mm (AWG24-18/1) |
| Insertion force | ≤ 30 N |
| Material: contacts | CuSn |
| Material: shield | German silver |
| Material: pressure screw | brass nickel-plated |
| Material: housing | zinc diecast nickel plated / brass nickel plated |
| Material: contact body | PA |
| Material: contacts | CuSn |
| | Au over Ni |

| | |
|--------------------------|--|
| Material: contact finish | |
|--------------------------|--|

| Electrical Characteristics | |
|--------------------------------|-------------|
| Contact resistance | ≤ 5 MΩ |
| Voltage proof: contact-contact | ≥ 500 V, DC |
| Insulation resistance | ≥ 100 MΩ |
| Voltage proof: contact-shield | ≥ 500 V, DC |

| Standards | |
|------------|-----------------|
| Connectors | IEC 61076-2-101 |

| | |
|--|------------------|
| Shock | 50 g |
| Protection against particulate ingress | IP6X |
| Protection against water / immersion | IPX7 |
| Ambient temperature | -40° C to +85° C |

| | |
|----------------------------------|-------------------------------|
| Fast Ethernet acc. to IEEE 802.3 | fulfilled |
| Category 5 | ISO/IEC 11801, DIN EN 50173-1 |