

# Power Supply Car Accessories Quick Start Guide

## 1. Introduction

Dear Customer! Thank you for your purchase in TME! To protect the environment we have prepared for you this quick start guide. Before operating the unit, please read it carefully. Please visit [www.tme.eu](http://www.tme.eu)  
Illustrations in this manual are only example images and may differ from the actual item. It does not change their main characteristics.

## 2. Application

The device is designed to power or charge devices such as car navigation systems, mobile phones, tablets.

## 3. Unit setup and operation

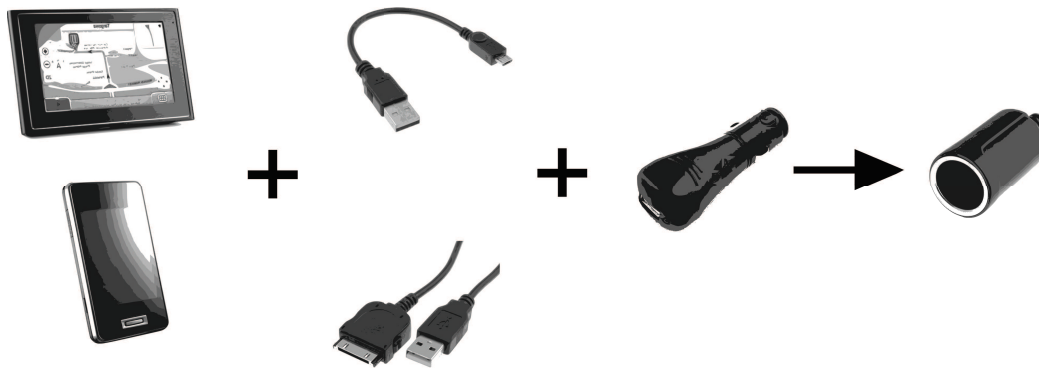

- Connect the plugs to the respective terminals in the car and in the external device.

## 4. Precautions

- Do not exceed the rated operating parameters.
- Use only as intended.
- Connect only to the 12V car installation.
- Please observe the correct polarization.
- Unplug the power supply from the power source immediately in case of damage to the housing, cables or plugs.
- Never let the power supply to become wet or to have any contact with liquids.



**Transfer Multisort Elektronik Sp. z o.o.**

ul. Ustronna 41, 93-350 Łódź, Poland, correspondence address: 90-951 Łódź 40, PO BOX 2071  
tel. +48 42 645 54 44, fax +48 42 645 54 70, [export@tme.eu](mailto:export@tme.eu), [www.tme.eu](http://www.tme.eu)

VAT ID: PL7290108984, REGON (NACE): 473171710, District Court for Łódź-Śródmieście, NCR: 0000165815, initial capital: 3 300 000 PLN